

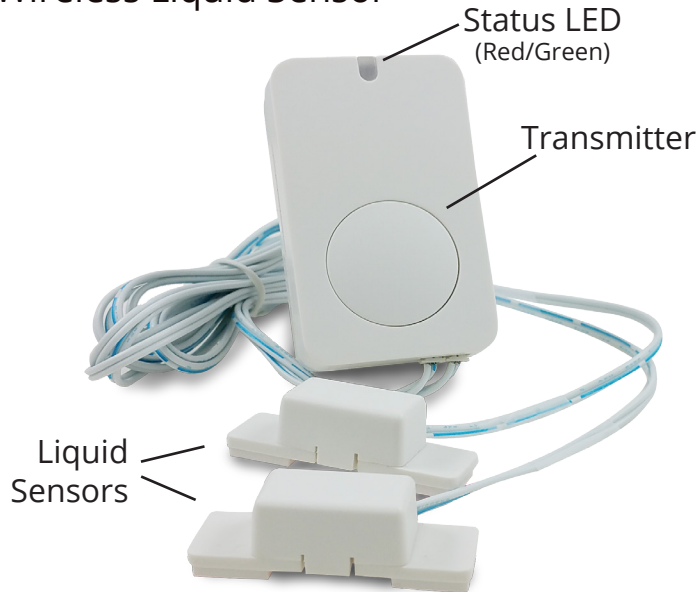

# Quick Start Guide - ZBLIQS Model #2030A

## Wireless Liquid Sensor



### Product Brief

ZBLIQS consists of two sensors that detect presence of liquid and a wireless transmitter that sends the sensors' signals to an enrolled device, alerting a user.

This device is battery powered and can easily be installed in hard-to-reach areas for maximum coverage. Low power consumption means an extended battery life.

### Installation

1. Remove battery cover, insert batteries (CR2450 x 2) and replace battery cover
2. Battery cover has double-sided tape to mount ZBLIQS to smooth surface\*
3. Follow Set-up procedure below to join to a ZigBee network

\* The transmitter is NOT waterproof/resistant and should be mounted in an area that is not likely to come in contact with liquid. For indoor use only.

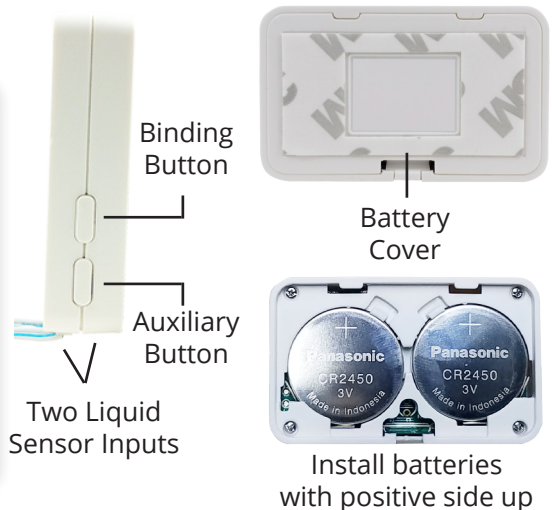

### Set-up

#### 1. Factory Reset ZBLIQS

- Press and hold the *Auxiliary Button* and *Binding Button*
- The Status LED will flash red twice. Keep holding both buttons until the Status LED begins to flash rapidly.

#### 2. Join Network

- Open a ZigBee router or coordinator to permit joining of your ZBLIQS to the network.
- Press the *Binding Button* of the ZBLIQS to turn the device on\*. Status LED will flash **green 5 times** after is has joined successfully.

\* ZBLIQS will go to "sleep" if it doesn't join a network within 15 seconds. Press the *Binding Button* every 15 seconds, until it joins, to prevent this. Do **not** press the *Binding Button* again if the Status LED is blinking **red**, or it will turn off.